

SPECIFICATION:

JOSAM PUSH-FIT TYPE 316L STAINLESS STEEL FITTING,
CROSS WITH EPDM GASKETED SOCKETS ON THREE ENDS.

**SS FITTING
PUSH-FIT
CROSS**

SERIES

JF

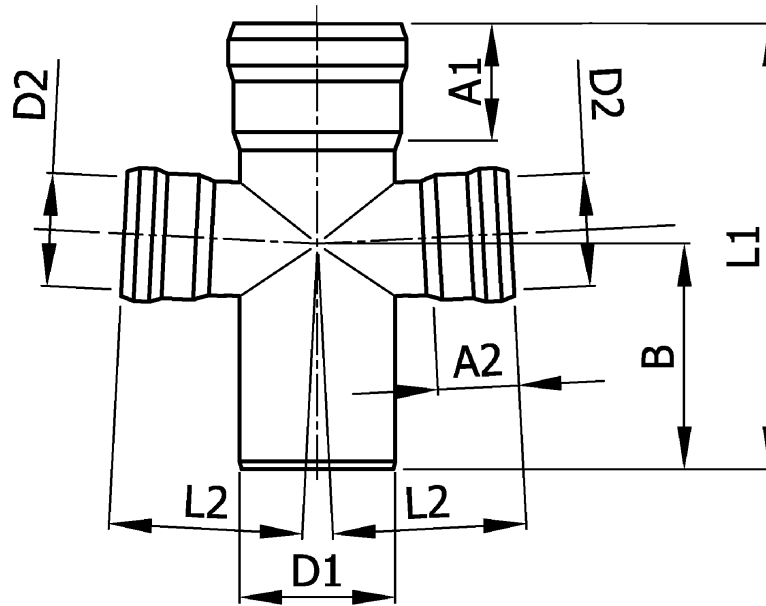

PART NO.	NOM. PIPE SIZE	D1 (PIPE O.D.)	D2 (PIPE O.D.)	A1 MIN. INSERT DEPTH	A2 MIN. INSERT DEPTH	L1	L2	B
JF-1851	2" X 1-1/2"	2.1 [53]	1.7 [42]	1.5 [38]	1.2 [30]	6.5 [165]	2.9 [73]	3.3 [84]
JF-1852	2" X 2"	2.1 [53]	2.1 [53]	1.5 [38]	1.5 [38]	6.5 [165]	3.2 [81]	3.3 [84]
JF-1854	3" X 2"	2.9 [73]	2.1 [53]	2.2 [55]	1.5 [38]	7.6 [192]	3.6 [91]	3.9 [98]
JF-1856	3" X 3"	2.9 [73]	2.9 [73]	2.2 [55]	2.2 [55]	8.2 [209]	4.3 [109]	4.2 [107]
JF-1860	4" X 3"	4.0 [102]	2.9 [73]	2.8 [70]	2.2 [55]	11.5 [291]	4.8 [123]	5.8 [148]
JF-1862	4" X 4"	4.0 [102]	4.0 [102]	2.8 [70]	2.8 [70]	11.5 [291]	5.4 [138]	5.8 [148]
JF-1864	6" X 4"	6.3 [159]	4.0 [102]	3.1 [80]	2.8 [70]	13.5 [343]	6.5 [166]	6.9 [175]
JF-1867	6" X 6"	6.3 [159]	6.3 [159]	3.1 [80]	3.1 [80]	15.9 [403]	7.0 [178]	8.1 [205]
JF-1874	8" X 4"	8.6 [219]	4.0 [102]	4.7 [120]	2.8 [70]	17.4 [441]	7.7 [196]	8.9 [225]
JF-1877	8" X 6"	8.6 [219]	6.3 [159]	4.7 [120]	3.1 [80]	17.4 [441]	8.2 [208]	8.9 [225]
JF-1878	8" X 8"	8.6 [219]	8.6 [219]	4.7 [120]	4.7 [120]	19.3 [491]	9.8 [249]	9.8 [250]

DIMENSIONS IN INCHES [mm] UNLESS OTHERWISE NOTED.

DATE OF LAST CHANGE: 7/20/18

DIMENSIONS ARE SUBJECT TO MANUFACTURERS TOLERANCES AND CHANGE WITHOUT NOTICE. WE CAN ASSUME NO RESPONSIBILITY FOR USE OF SUPERSEDED OR VOID DATA.

JOSAM

MICHIGAN CITY, INDIANA

NOTES